



Chatswood Chase Sydney

345 Victoria Avenue, Chatswood NSW 2067
chatswoodchasesydney.com.au



Chatswood Chase Sydney is a four level Major Regional shopping centre located approximately 10 kilometres north of the Sydney CBD. It is anchored by David Jones, Kmart and Coles and includes more than 135 speciality stores. Chatswood Chase Sydney features iconic international and Australian brands such as Aje., Apple, Coach, Furla, Hugo Boss, Incu, maje, Max & Co, MECCA, Nespresso, Polo Ralph Lauren, Pottery Barn, Sandro, Tommy Hilfiger, West Elm, Williams-Sonoma and Zimmermann.

Property overview

State	NSW
Centre type	Major Regional
Ownership interest (%)	Vicinity Centres – 51
Co-owner (%)	GIC – 49
Date acquired*	2003
Centre first opened	1980
Latest redevelopment	2009
Valuation External/Internal	External
Valuation (\$m) ¹	859.7
Valuation date	Dec-20
Capitalisation rate (%)	5.00
Discount rate (%)	6.50

Property metrics

Gross lettable area (GLA) (sqm)	63,619
Number of tenants	164
Total Trade Area (000's)	466
Major tenants ²	Coles, David Jones, Kmart
Car spaces	2,434
Occupancy rate by GLA (%) ³	n.a.
Weighted average lease expiry by GLA (years)	3.8
Green Star – Performance	3 Stars
NABERS Energy rating	3.5 Stars
NABERS Water rating	1.5 Stars

Note: Some asset metrics have not been reported this period due to COVID-19 impacts.

* Acquired 50% in 2003, acquired 50% in 2007 and divested 49% in 2018.

1 Expressed on 100% basis.

2 Classified in accordance with SCCA guidelines, typically includes department stores, discount department stores, supermarkets and cinemas.

3 Occupancy rate non-comparable for reporting purposes.

4 Includes holdovers.

Tenant mix by gross lettable area (GLA)

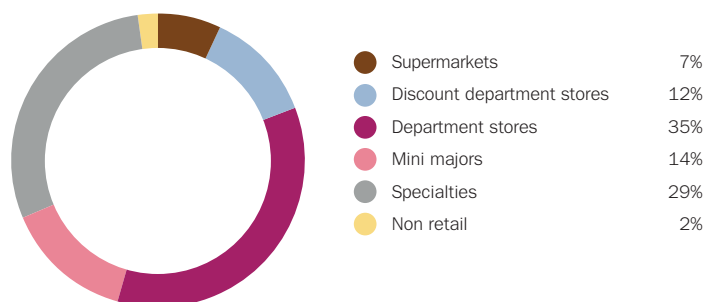

Specialty store lease expiry profile by income

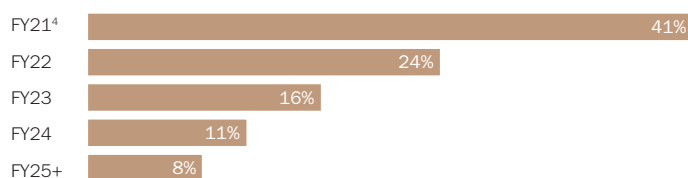

GROUND LEVEL

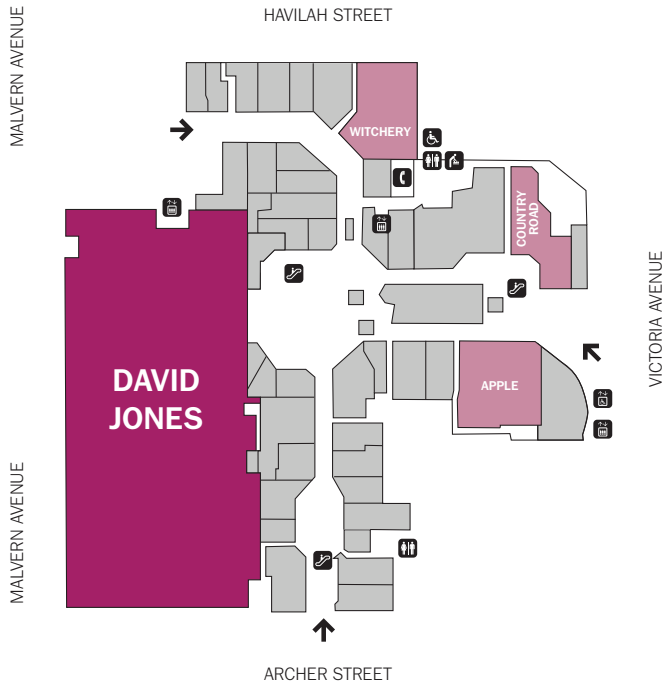

LEVEL TWO

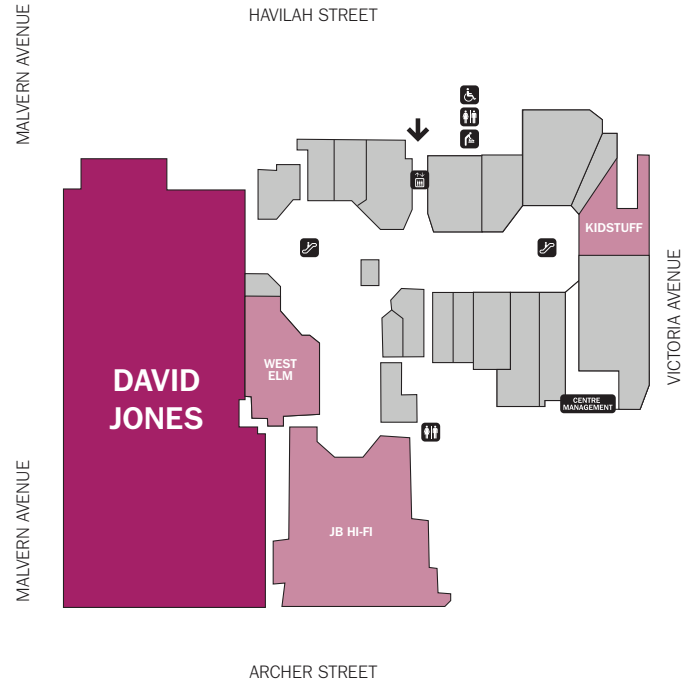

LOWER GROUND LEVEL

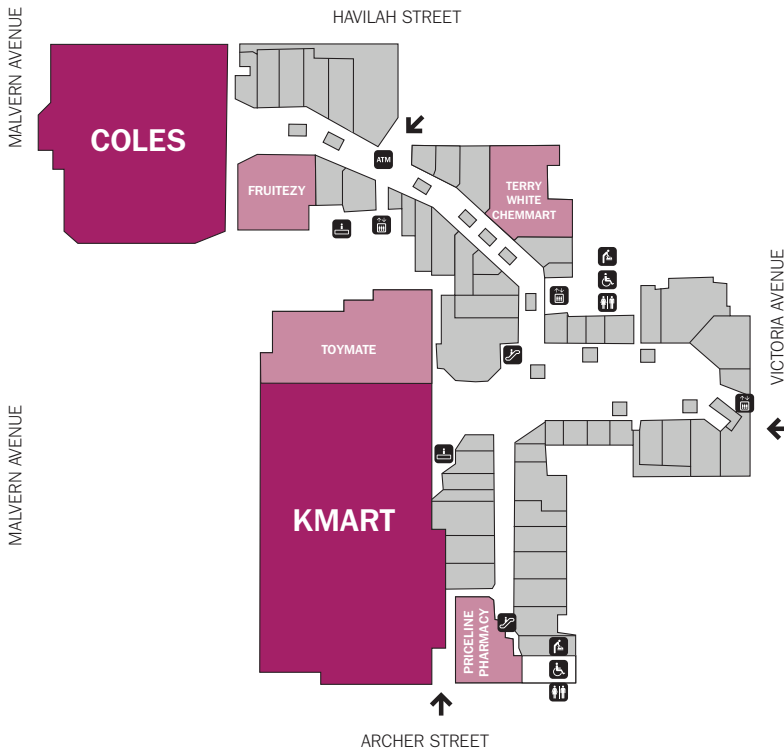

LEVEL ONE

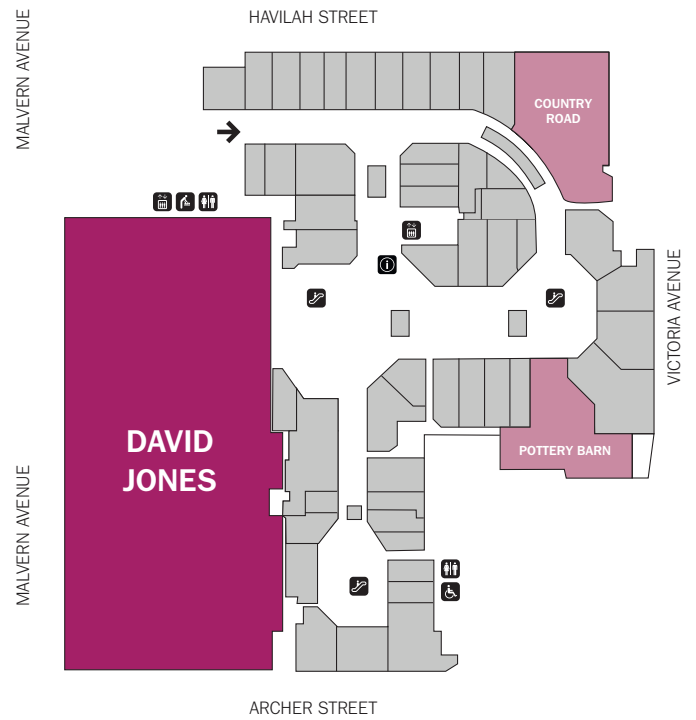

- MAJORS
- MINI MAJORS
- SPECIALTIES
- ENTRANCES →